

**RIGHT ANGLE PLUG CRIMP TYPE  
CABLE 5/50 D**

**R161.183.117**  
**SERIES N**

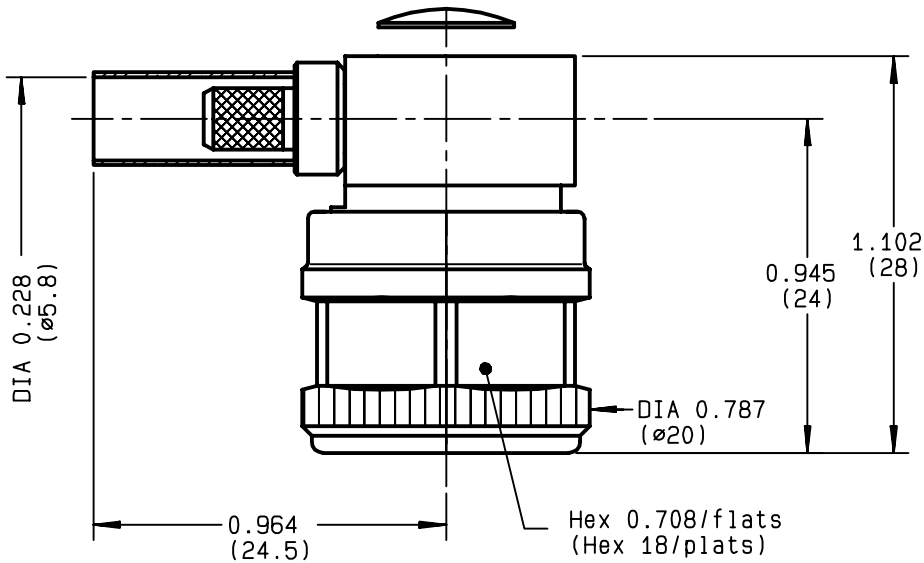

NOMINAL IMPEDANCE	<b>50</b> Ω
FREQUENCY RANGE	<b>0-11</b> GHz
TEMPERATURE RATING	<b>-55/+155</b> °C
V.S.W.R	<b>1.15*</b> + x F(GHz)Maxi
RF INSERTION LOSS	<b>0.07</b> √F(GHz) dB Maxi
VOLTAGE RATING	<b>850</b> Veff Maxi
DIELECTRIC WITHSTANDING VOLTAGE	<b>1500</b> Veff Mini
INSULATION RESISTANCE	<b>5000</b> MΩMini
HERMETIC SEAL	<b>NA</b> Atm.cm <sup>3</sup> /s
LEAKAGE (pressurized only)	<b>NA</b>
MECHANICAL DURABILITY	<b>500</b> Cycles
WEIGHT	<b>44</b> gr
SPECIFICATION	<b>* 0-2 GHz</b>

CABLES : **KX 23**  
**RG 142**  
**RG 142 FTX**  
**RG 223**  
**RG 400**

OTHERS CHARACTERISTICS

**PIM3 < -155 dBc (-112 dBm) 2x20W**

CABLE RETENTION	<b>200</b> N Mini
CENTER CONTACT RETENTION	
Axial force - mating end	<b>27</b> N Mini
Axial force - opposite end	<b>27</b> N Mini
Torque	<b>NA</b> cm.N Mini
RECOMMENDED TORQUES	
Mating	<b>170</b> cm.N
Panel nut	<b>NA</b> cm.N
Clamp nut	<b>NA</b> cm.N

CONNECTOR PARTS	MATERIALS	FINISH	(all values are given ) in micrometers
BODY	BRASS	BBR 0.5 OVER SILVER 3	
OUTER CONTACT	BRASS	BBR 0.5 OVER SILVER 3	
CENTER CONTACT	BRASS	GOLD 2.5 OVER COPPER 2.5	
INSULATOR	PTFE	-	
GASKET	SILICONE RUBBER	-	
OTHERS PIECES	BRASS	BBR 0.5 OVER SILVER 3	

ISSUE	CREATION DATE	FILE PART-NUMBER
<b>9806D00</b>	<b>07/12/1993</b>	<b>EPC 96-07</b>



**RADIALL**®

GAUTIER

The information given here is subject to change without notice.  
Design changes may be in order to improve the product .

*Connect to the future*



**R161.183.117**  
 ISSUE 9806D00 SERIES N

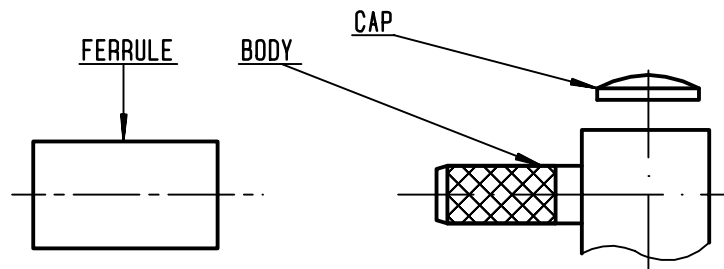

①

Slide the ferrule onto the cable.  
 Strip the cable .  
 -  
 -

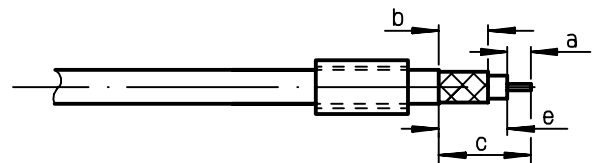

Stripping	a	b	c	d	e
inch	0.138	0.276	0.709	0	0.571
mm	3.5	7	18		14.5

②

Fan the braid .  
 Push connector body under the braid .  
 Slide the ferrule on the braid  
 ( in direction F )  
 -  
 -

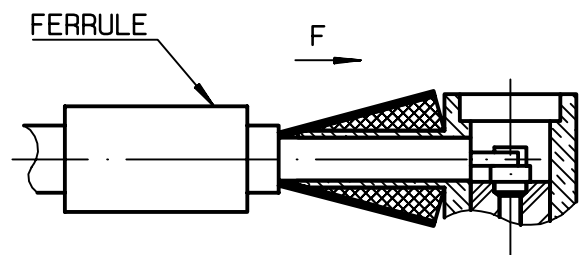

③

Crimp the ferrule with crimping tool  
 R282 223 000 (hex: 0.212) or  
 crimping tool R282 293 000 (M22520/5-01)  
 + dies R282 235 011 (M22520/5-11)  
 Solder inner conductor .

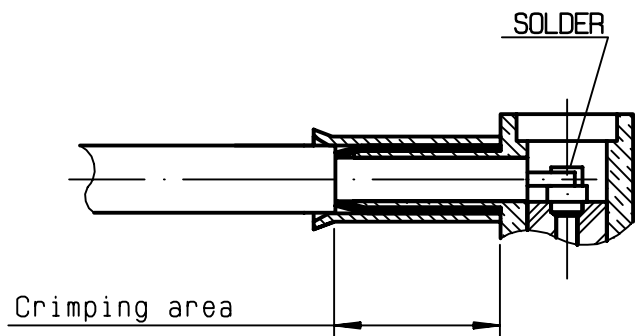

④

Place the cap .  
 Press cap flush or slightly below surface  
 of body assembly .  
 -  
 -  
 -

